



www.masterlockatwinch.com
Order: 866-835-0628
Phone: 712-338-2974
FAX: 800-245-7569
E-MAIL: masterlock@cyclecountry.com

WINCH MOUNT KIT

Installation Instructions

KIT NUMBER: 20-8300



www.masterlockatwinch.com
Order: 866-835-0628
Phone: 712-338-2974
FAX: 800-245-7569
E-MAIL: masterlock@cyclecountry.com

ONE YEAR LIMITED WINCH MOUNT WARRANTY

For the period of one year from the purchase date Master Lock will replace for the original purchaser, free of charge, any part or parts, when found, upon examination by Master Lock, to be defective in material, workmanship, or both.

All transportation cost incurred by the purchaser in submitting the material to Master Lock for replacement under this warranty, must be borne by the purchaser. If Master Lock determines that the product must be returned to the factory for credit please call 1-866-835-0628 for an RMA number and shipping instructions.

The warranty does not apply to parts that have been damaged by accident, alteration, abuse, improper lubrication, normal wear, or other causes beyond Master Lock's control.

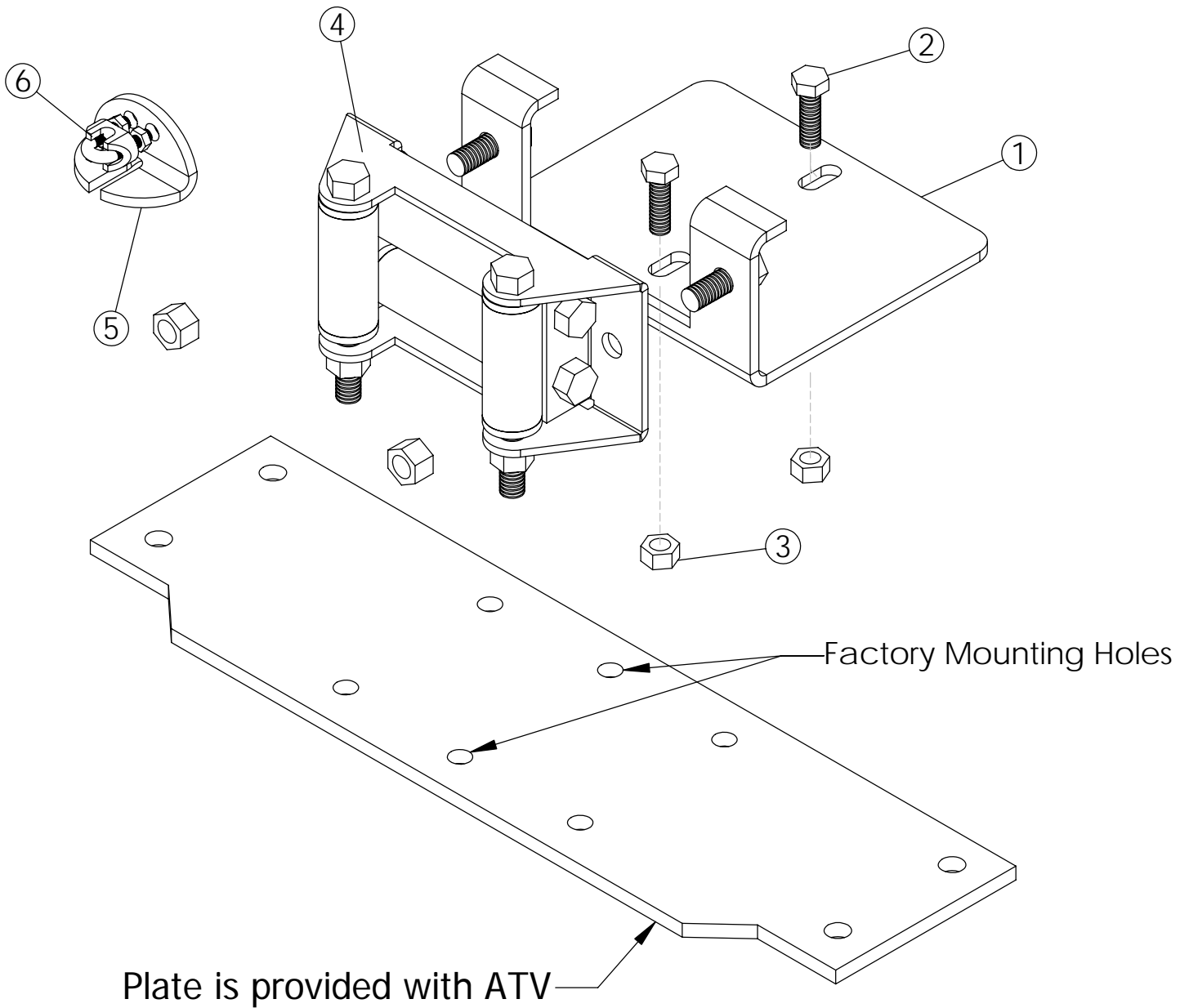

#20-8300 Parts List

ITEM NO.	QTY.	PART NO.	DESCRIPTION
1	1	CYC5318	Roller Hawse Mount Plate
2	2	PUR1155	5/16" x 1" Bolt Gr 5
3	2	PUR1275	Nut 5/16" Nylock
4	1	11044	Roller Hawse Assembly
5	1	CYC0882	Cable Stop
6	1	PUR1606	3/16" Cable Clamp

Refer to the winch manual for winch mounting instructions.

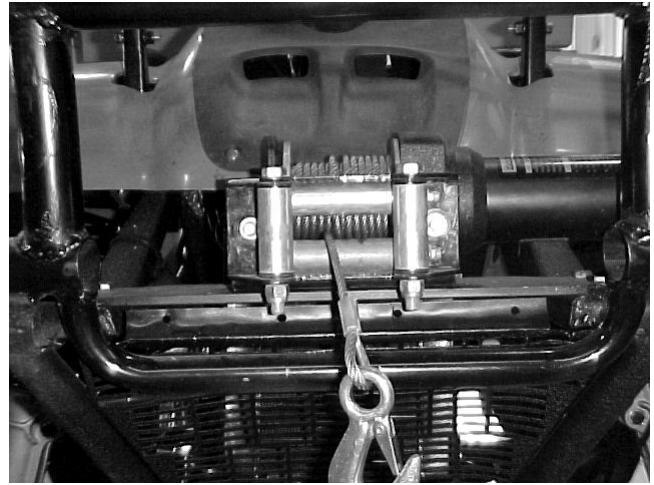

Winch mount plate drill procedure.

1. Locate the existing winch mount plate provided with the ATV.
2. Using the mount plate holes provided with the ATV, align the roller hawse holes to the holes on the mount plate. Making sure you locate the best set of holes that have no clearance problems.
3. Mount the roller hawse to the plate using the two 3/8" x 1" bolts and locknuts
4. Remove one of the long rollers and feed the winch cable through the roller hawse. Next reinstall the roller. Be sure the roller moves freely
5. Mount the winch to the roller hawse plate and the ATV mount plate using the located holes 5/16" x 1" bolts and lock nuts
6. Install the cable stop on your winch cable to prevent damage to the winch.

***CAUTION**

**BE AWARE OF WHEN THE CABLE STOP CONTACTS THE ROLLER HAWSE AS CABLE IS WOUND IN.
FAILURE TO RELEASE MAY CAUSE DAMAGE TO WINCH PARTS OR TO THE ATV.**

When using the winch to raise and lower a blade a cable stop must be installed.

Carefully raise the blade until the top of the push tube's are no closer than 1" anywhere on the ATV. Place the Cable Stop onto the Winch Cable up against the Winch Hawse. Secure the Cable Stop to the Winch Cable using the Cable Clamp Assembly as shown in the pictures below.

